



VGB

ISO 14540 - WITH POPPET/BALL

Edition. 21.3

CS Carbon Steel

- Type: Quick Couplings
- Models: ISO 14540
- Sizes: from DN6 up to DN10
- Pressure: up to PN700
- Treatment: Galvanized

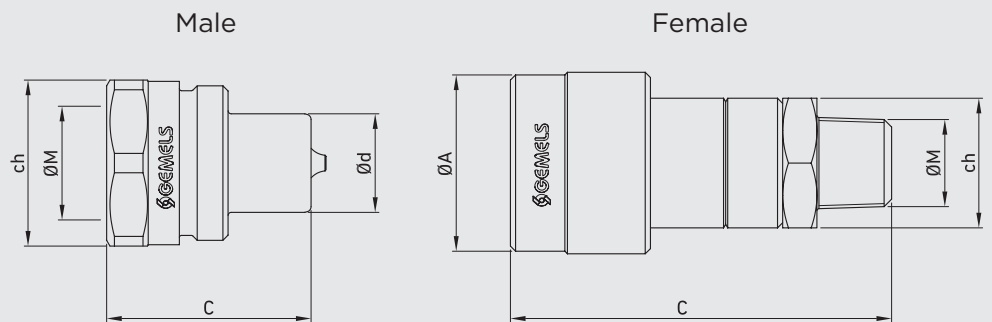

Available also
in patented version:
ball valve with integrated
quick coupling.

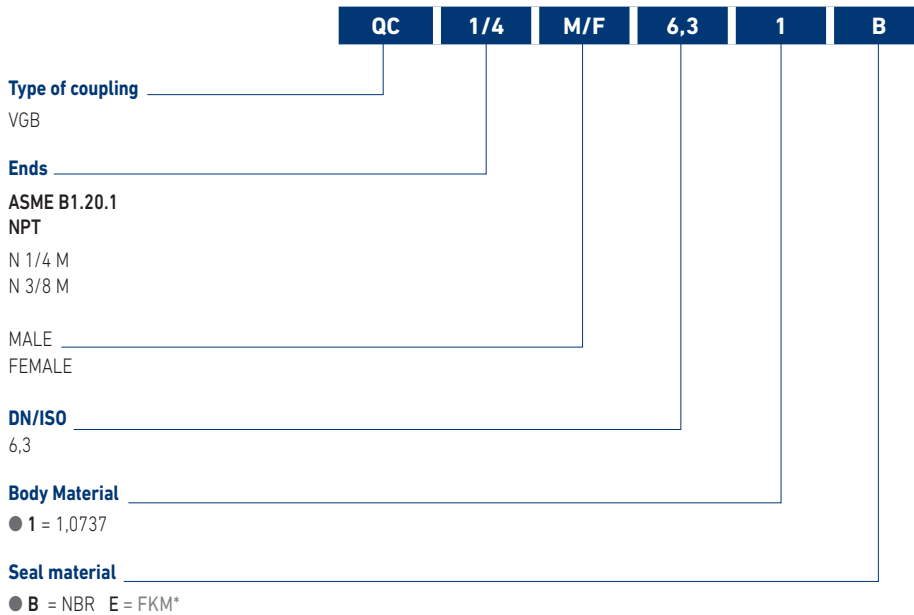

CODE DESCRIPTION STRUCTURE

*On request
 • Plugs
 with ball instead of poppet

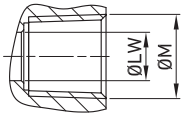
**QUICK COUPLINGS ISO 14540 VGB (MALE/FEMALE)
 MALE THREAD ASME B1.20.1 NPT WITH POPPET**

TYPE	DN	PN	ØA	C	Ød	ch	ØM	WEIGHT	ITEM CODE
QC VGB N 1/4M MALE	6,3	MPa 70	mm -	32,5	15,9	19	NPT 1/4	kg 0,113	NC17N010000
		Psi 10150	inch -	1,28	0,63			lb 0,25	
QC VGB N 1/4M FEMALE	6,3	MPa 70	mm 28,5	60,8	-	22	NPT 1/4	kg 0,07	NC18N010000
		Psi 10150	inch 1,12	2,39	-			lb 0,15	
QC VGB N 3/8M MALE	10	MPa 70	mm -	35	19	32	NPT 3/8	kg 0,221	NC17N020000
		Psi 10150	inch -	1,38	0,75			lb 0,49	
QC VGB N 3/8M FEMALE	10	MPa 70	mm 35	75,3	-	25	NPT 3/8	kg 0,111	NC18N020000
		Psi 10150	inch 1,38	2,96	-			lb 0,24	

CS
Carbon Steel

**QUICK COUPLINGS ISO 14540 VGB (MALE/FEMALE)
 MALE THREAD ASME B1.20.1 NPT WITH BALL**

TYPE	DN	PN	ØA	C	Ød	ch	ØM	WEIGHT	ITEM CODE
QC VGB N 1/4M BALL MALE	6,3	MPa 70	mm -	32,5	15,9	19	NPT 1/4	kg 0,113	NC17N010001
		Psi 10150	inch -	1,28	0,63			lb 0,25	
QC VGB N 1/4M BALL FEMALE	6,3	MPa 70	mm 28,5	60,8	-	22	NPT 1/4	kg 0,07	NC18N010001
		Psi 10150	inch 1,12	2,39	-			lb 0,15	
QC VGB N 3/8M BALL MALE	10	MPa 70	mm -	35	19	32	NPT 3/8	kg 0,221	NC17N020001
		Psi 10150	inch -	1,38	0,75			lb 0,49	
QC VGB N 3/8M BALL FEMALE	10	MPa 70	mm 35	75,3	-	25	NPT 3/8	kg 0,111	NC18N020001
		Psi 10150	inch 1,38	2,96	-			lb 0,24	

CS
Carbon Steel