



N

ISO 5675 - WITH BALL

Edition. 21.2

CS Carbon Steel

- Type: Quick Couplings
- Models: ISO 5675
- Sizes: from DN6 to DN25
- Pressure: up to PN350
- Treatment: Galvanized

Male

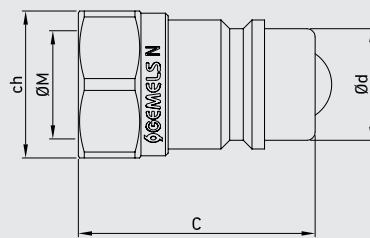

Female

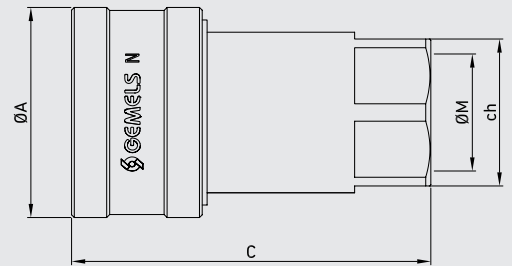

Available also in patented version: ball valve with integrated quick coupling.

Performance

(1/4", 3/8", 1/2", 3/4", 1")
 Series (1/4", 3/8", 1/2", 3/4", 1")
 200SUS (Test Fluid: Oil-200SUS)

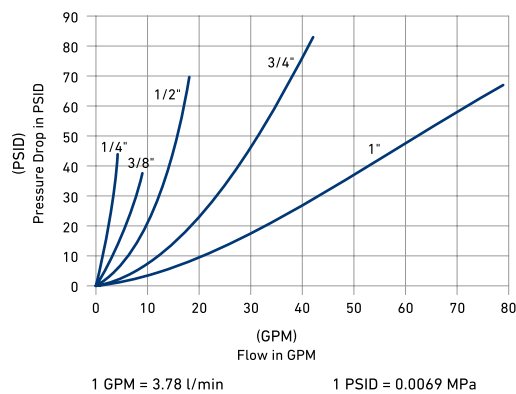



CODE DESCRIPTION STRUCTURE

QC	1/2	M/F	DN12,5	1	B
----	-----	-----	--------	---	---

Type of coupling

ISO 5675 N

Ends

ISO 1179-1	ASME B1.20.1
BSPP	NPT
G 1/4	N 1/4
G 3/8	N 3/8
G 1/2	N 1/2
G 3/4	N 3/4
G 1	N 1

MALE
FEMALE

DN/ISO

6,3
10
12,5
20
25

Body Material

● 1 = 1,0737

Seal material

B = NBR E = FKM*

*On request

- Plugs
- Cups

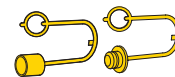

Available colours:

- Blue
- Yellow
- Red
- Green

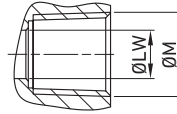
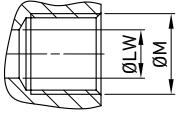

**QUICK COUPLINGS ISO 5675
(male / female)
FEMALE THREAD ISO 1179-1 BSPP
WITH BALL**

CS
Carbon
Steel

TYPE	DN	PN	ØA	C	Ød	ch	ØM	WEIGHT	ITEM CODE
QC N G 1/4 MALE	6,3	MPa 35	mm -	36	14,2	19	G 1/4	kg 0,04	NC07G010000
		Psi 5075	inch -	1,42	0,56	0,75		lb 0,09	
QC N G 1/4 FEMALE	6,3	MPa 35	mm 27,6	53,5	-	19	G 1/4	kg 0,11	NC08G010000
		Psi 5075	inch 1,09	2,11	-	0,75		lb 0,24	
QC N G 3/8 MALE	10	MPa 28	mm -	40	19	24	G 3/8	kg 0,08	NC07G020000
		Psi 4060	inch -	1,57	0,75	0,94		lb 0,18	
QC N G 3/8 FEMALE	10	MPa 28	mm 34	63	-	24	G 3/8	kg 0,2	NC08G020000
		Psi 4060	inch 1,34	2,48	-	0,94		lb 0,44	
QC N G 1/2 MALE	12,5	MPa 28	mm -	43,5	20,5	27	G 1/2	kg 0,09	NC07G030000
		Psi 4060	inch -	1,71	0,81	1,06		lb 0,20	
QC N G 1/2 FEMALE	12,5	MPa 28	mm 38,6	66,3	-	27	G 1/2	kg 0,27	NC08G030000
		Psi 4060	inch 1,52	2,61	-	1,06		lb 0,60	
QC N G 3/4 MALE	20	MPa 20	mm -	53,5	28	34	G 3/4	kg 0,182	NC07G040000
		Psi 2900	inch -	2,11	1,10	1,34		lb 0,40	
QC N G 3/4 FEMALE	20	MPa 20	mm 48,2	82,5	-	34	G 3/4	kg 0,515	NC08G040000
		Psi 2900	inch 1,90	3,25	-	1,34		lb 1,14	
QC N G 1 MALE	25	MPa 20	mm -	63	31,3	41	G 1	kg 0,246	NC07G050000
		Psi 2900	inch -	2,48	1,23	1,61		lb 0,54	
QC N G 1 FEMALE	25	MPa 20	mm 56	96,5	-	41	G 1	kg 0,817	NC08G050000
		Psi 2900	inch 2,20	3,80	-	1,61		lb 1,80	

**QUICK COUPLINGS ISO 5675
(male / female)
FEMALE THREAD ASME B1.20.1
NPT WITH BALL**

CS
Carbon
Steel

TYPE	DN	PN	ØA	C	Ød	ch	ØM	WEIGHT	ITEM CODE
QC N N 1/4 MALE	6,3	MPa 35	mm -	36	14,2	19	NPT 1/4	kg 0,04	NC07N010000
		Psi 5075	inch -	1,42	0,56	0,75		lb 0,09	
QC N N 1/4 FEMALE	6,3	MPa 35	mm 27,6	53,5	-	19	NPT 1/4	kg 0,11	NC08N010000
		Psi 5075	inch 1,09	2,11	-	0,75		lb 0,24	
QC N N 3/8 MALE	10	MPa 28	mm -	40	19	24	NPT 3/8	kg 0,08	NC07N020000
		Psi 4060	inch -	1,57	0,75	0,94		lb 0,18	
QC N N 3/8 FEMALE	10	MPa 28	mm 34	63	-	24	NPT 3/8	kg 0,2	NC08N020000
		Psi 4060	inch 1,34	2,48	-	0,94		lb 0,44	
QC N N 1/2 MALE	12,5	MPa 28	mm -	43,5	20,5	27	NPT 1/2	kg 0,09	NC07N030000
		Psi 4060	inch -	1,71	0,81	1,06		lb 0,20	
QC N N 1/2 FEMALE	12,5	MPa 28	mm 38,6	66,3	-	27	NPT 1/2	kg 0,27	NC08N030000
		Psi 4060	inch 1,52	2,61	-	1,06		lb 0,60	
QC N N 3/4 MALE	20	MPa 20	mm -	53,5	28	34	NPT 3/4	kg 0,09	NC07N040000
		Psi 2900	inch -	2,11	1,10	1,34		lb 0,20	
QC N N 3/4 FEMALE	20	MPa 20	mm 48,2	82,5	-	34	NPT 3/4	kg 0,27	NC08N040000
		Psi 2900	inch 1,90	3,25	-	1,34		lb 0,60	
QC N N 1 MALE	25	MPa 20	mm -	63	31,3	41	NPT 1	kg 0,09	NC07N050000
		Psi 2900	inch -	2,48	1,23	1,61		lb 0,20	
QC N N 1 FEMALE	25	MPa 20	mm 56	96,5	-	41	NPT 1	kg 0,27	NC08N050000
		Psi 2900	inch 2,20	3,80	-	1,61		lb 0,60	